

## Insulated Terminal Block

- **Fully Insulated Design:** Ensures safe, no exposed metal connections
- **Durable Construction:** Molded phenolic housing provides strength and heat resistance
- **Quick-Connect Terminals:** .250" × .031" male tabs for fast, reliable wiring
- **Terminal Styles:** Available in "U" or "Spade" configurations
- **UL Flame Rating:** UL 94 V-1 rated for flame retardancy
- **Clear Identification:** Optional terminal markings and circuit legends can be imprinted
- UL E61937 & CSA 2606851
  - Current: 25A
  - Voltage: 250V
  - Temperature Rating: 150°C

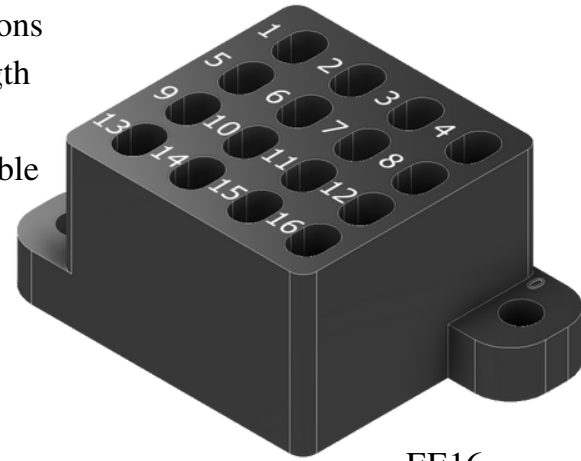

EE16

## EE8 Block

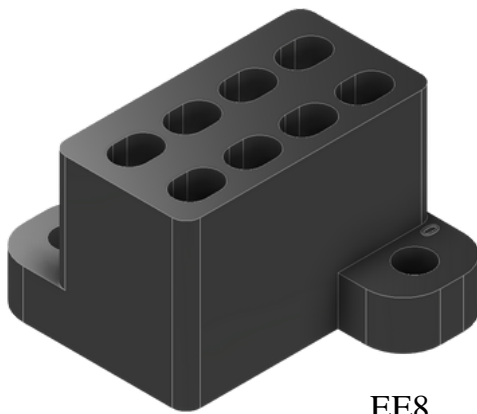

EE8

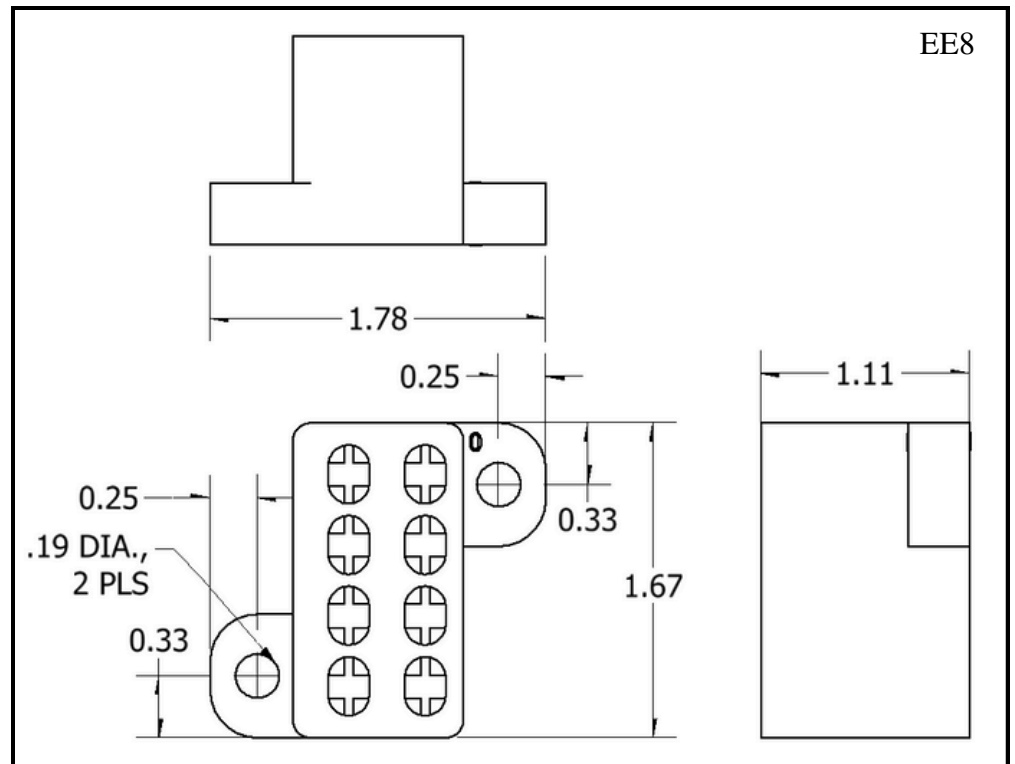

*All dimensions are in inches*

## EM12 & EE16 Block

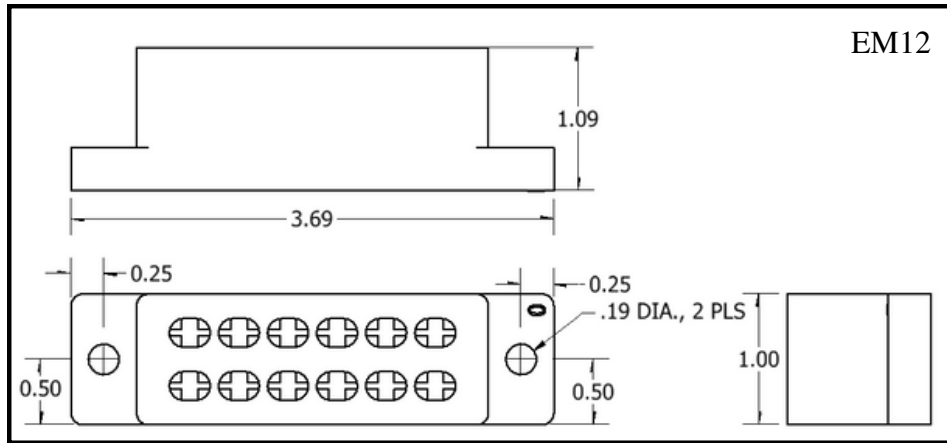

EM12

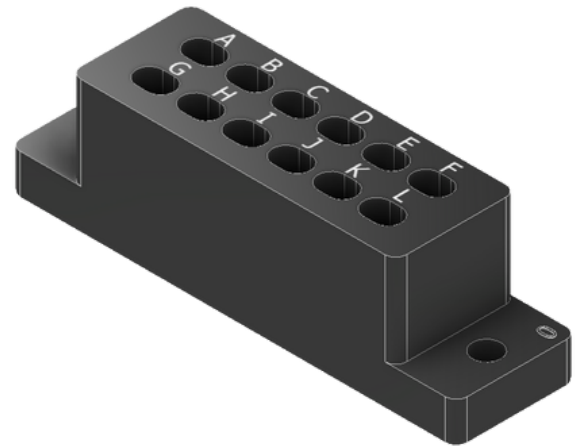

EM12

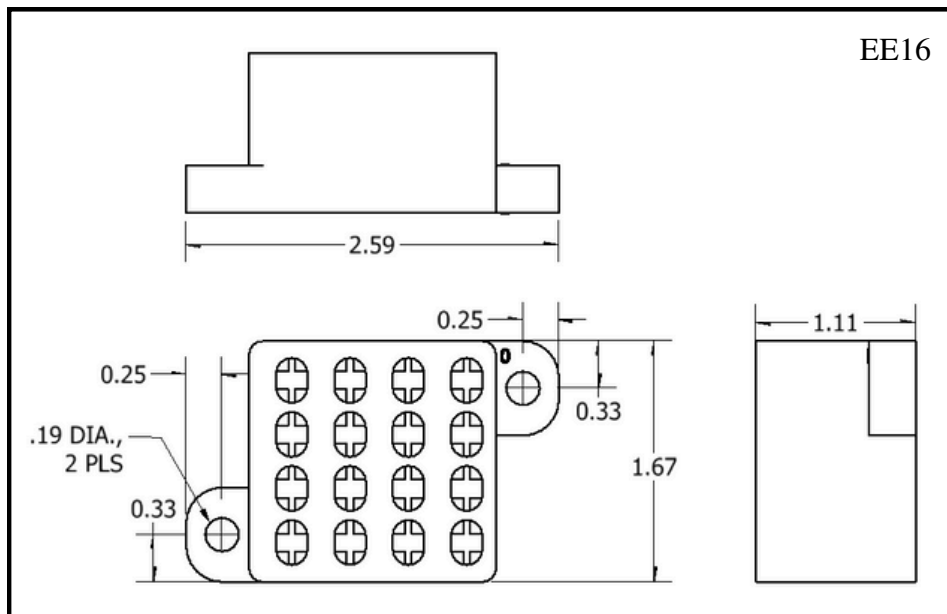

EE16

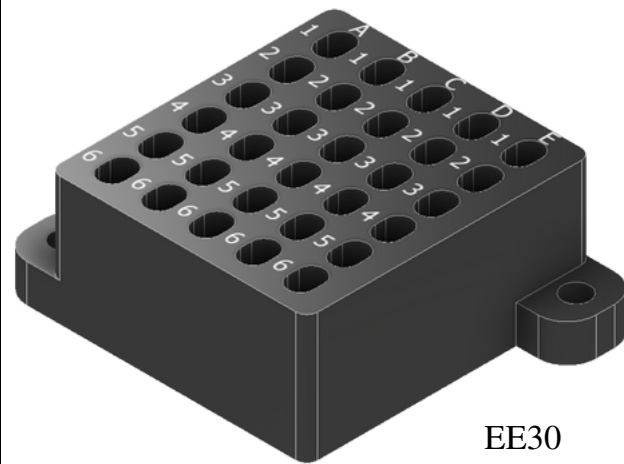

EE30

## EE30 Block

All dimensions are in inches

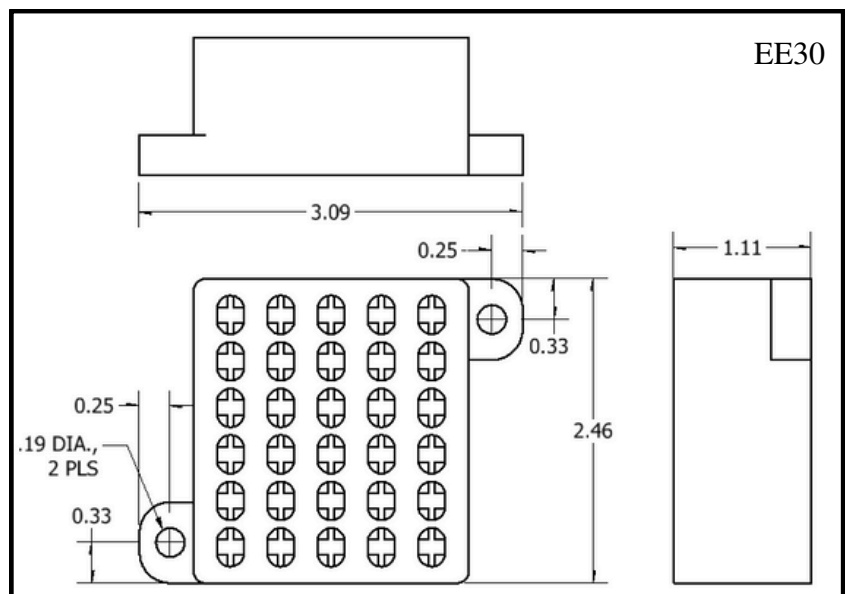

EE30

All dimensions are in inches

## Design Your Own Block (EE8 & EM12)

- Using either the U or Spade Tab style, design your block using the options below.
- Notate which Tab style you are using
- If you are using multiple tab styles, note which style you want for each terminal

*Tabs may be placed in any cardinal direction*



6

### U Style

2, 4, 6, 8, 10 and 12 Tabs

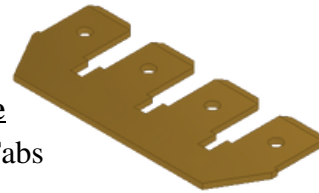

### Spade Style

2,3,4,5 and 6 Tabs

4

## Notation

### Spade Style

6 tabs   5 tabs   4 tabs   3 tabs   2 tabs

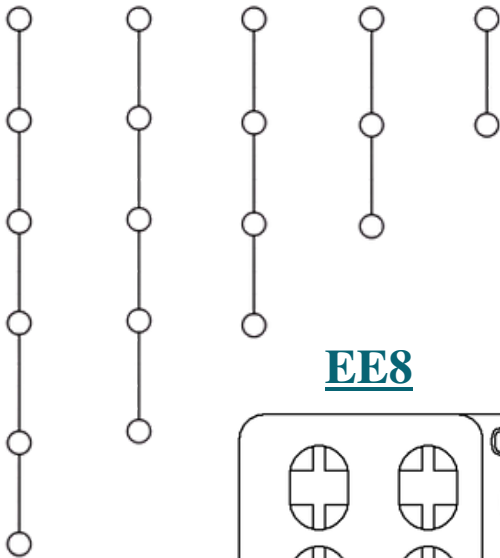

### EE8

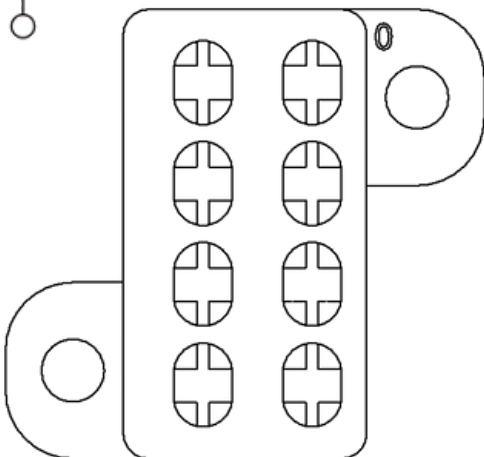

### U Style

2 tabs   4 tabs   6 tabs   8 tabs   10 tabs   12 tabs

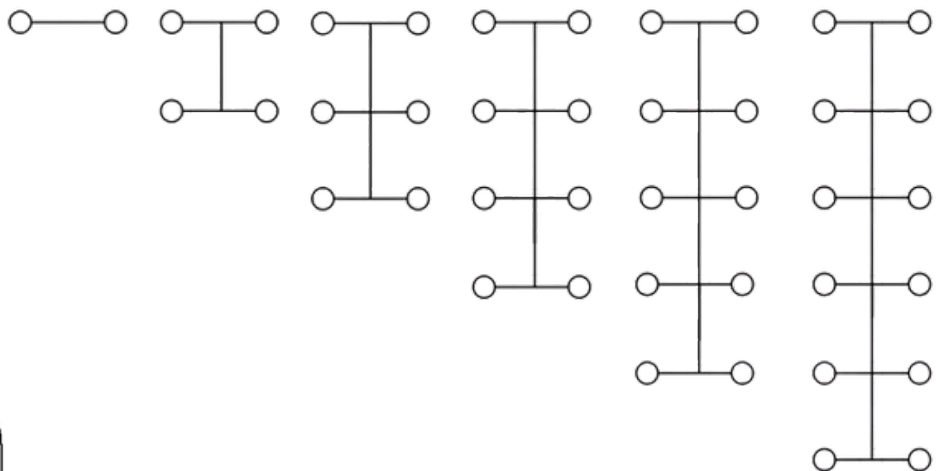

### EM12

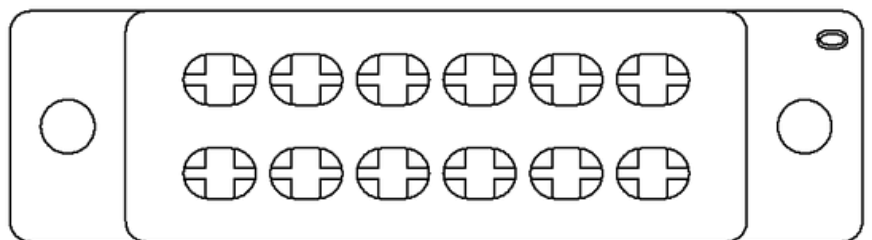

## Design Your Own Block (EE16 & EE30)

- Using either the U or Spade Tab style, design your block using the options below.
- Notate which Tab style you are using
- If you are using multiple tab styles, note which style you want for each terminal

*Tabs may be placed in any cardinal direction*

### Notation



**U Style**

2, 4, 6, 8, 10 and 12 Tabs

8

**Spade Style**

2,3,4,5 and 6 Tabs

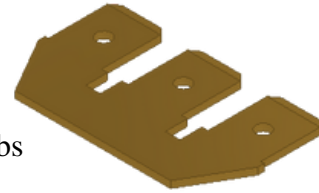

3

**Spade Style**

6 tabs 5 tabs 4 tabs 3 tabs 2 tabs

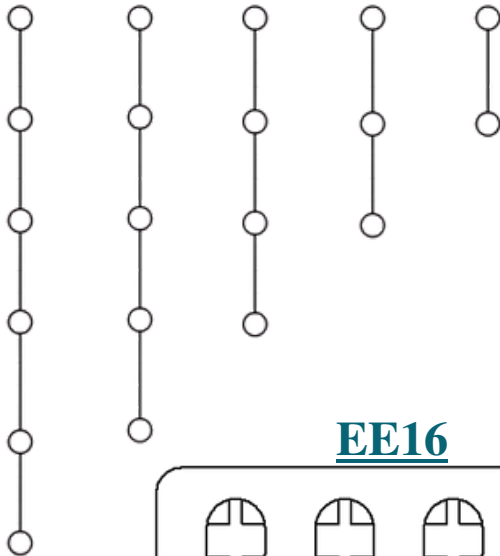

**U Style**

2 tabs 4 tabs 6 tabs 8 tabs 10 tabs 12 tabs

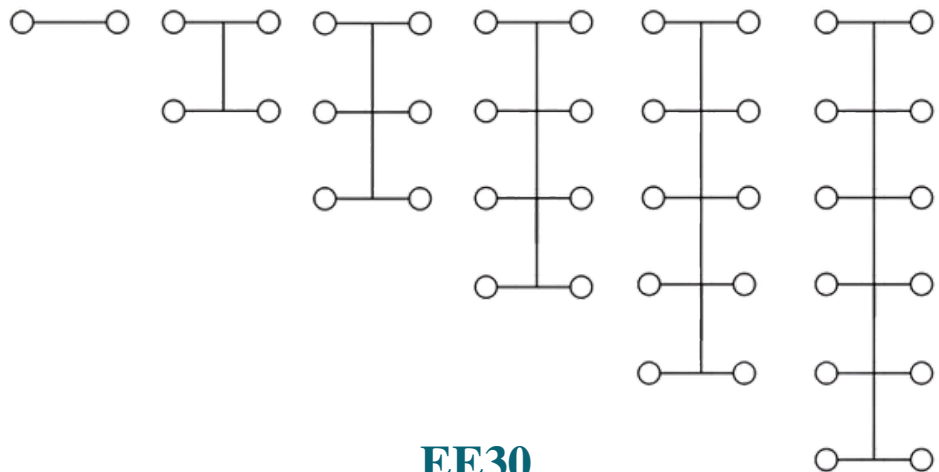

**EE16**

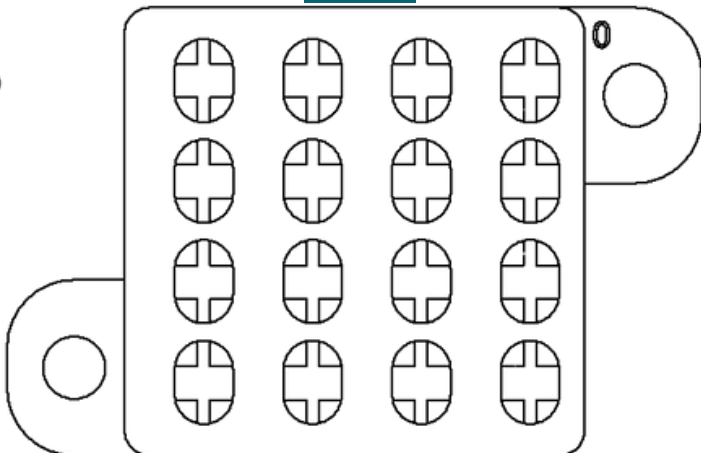

**EE30**

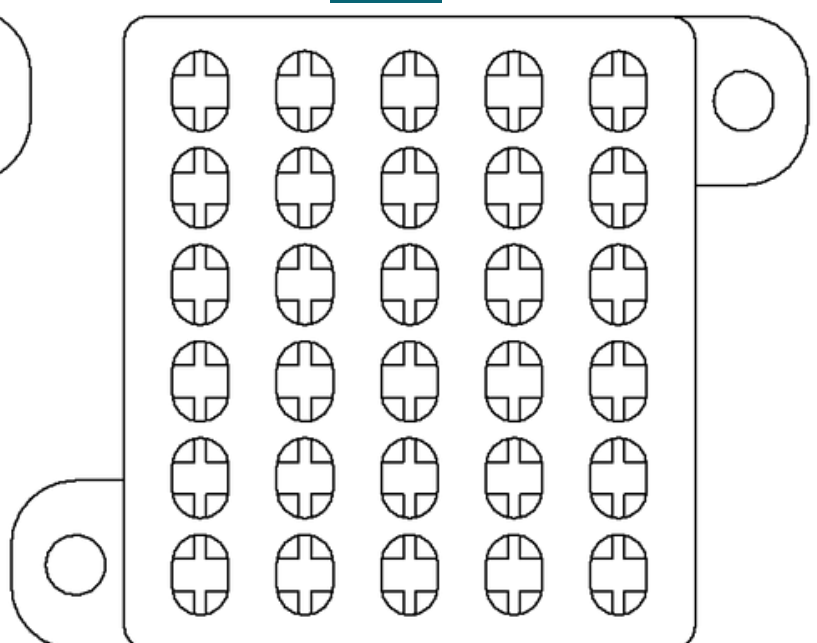

Spade Style Tab  
U Style Tab

## Popular Configurations

EE16-204

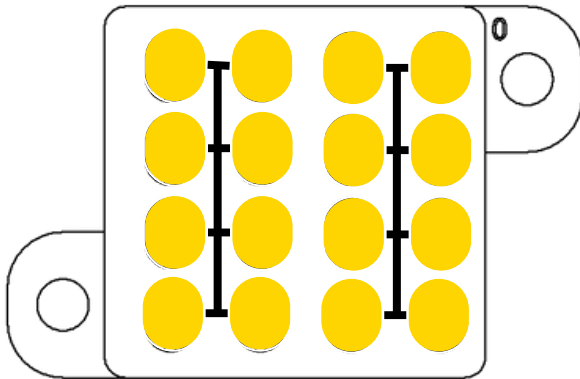

EE16-210

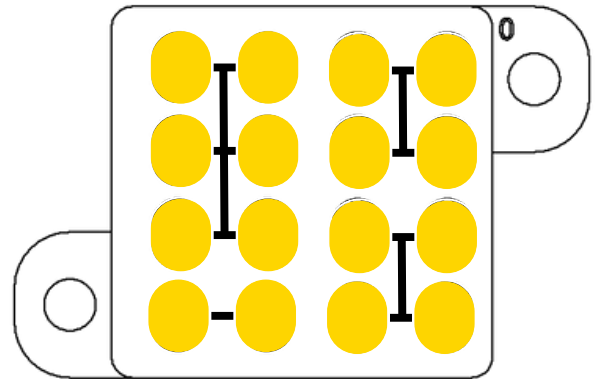

EE8-205

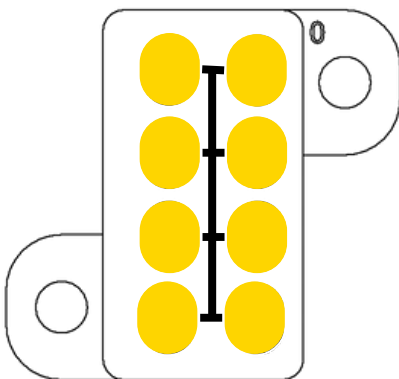

EE30-1

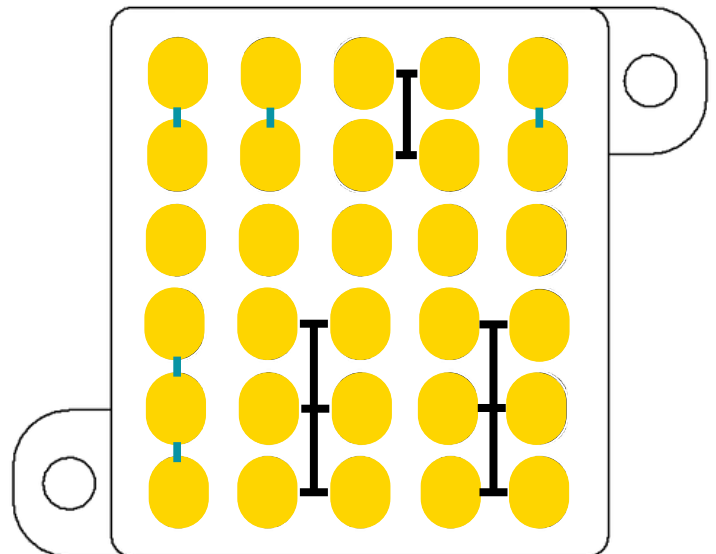

EM12-208

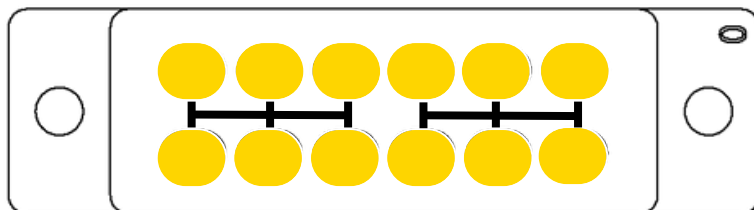

EM12-211

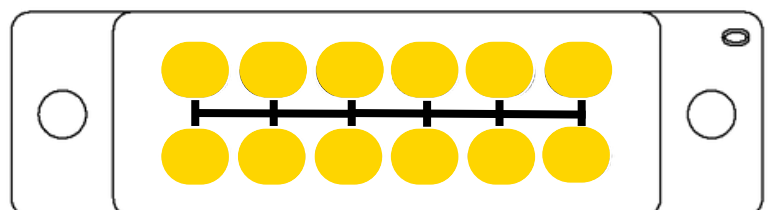

## Insulated Terminal Block

Ordering #: EE16-210

**Fully Insulated Design:** Engineered for applications requiring “no exposed metal” connections

**Compact & Cost-Efficient:** Saves space while providing secure internal junctions

**Pole Options:** Available in models with 2 to 15 poles, depending on series

**Terminal Capacity:** Supports from 2 to 30 terminals, with 2 to 12 common connections

**Tab Configuration:** Nearly endless arrangements of ¼" quick-connect tabs

**Tab Specs:** .031" x .250" male quick-connect tabs in “U” or “Spade” style

**Durable Base Material:** Molded electrical-grade phenolic, rated for 150°C

**Certified Ratings:** UL & CSA listed for 25A, 250V, 150°C continuous duty

**Optional Markings:** Terminal identification, circuit legends, and part numbers can be imprinted on the top or side

**UL Flame Rating:** UL 94 V-1 rated for flame retardancy

**Appliance Ready:** Ideal for ovens, dryers, HVAC, and other compact, high-performance appliance wiring needs

### Series Range:

EE8: Up to 4 poles, 8 terminals

EM12: Up to 6 poles, 12 terminals

EE16: Up to 8 poles, 16 terminals

EE30: Up to 15 poles, 30 terminals

IN  
STOCK



### EE16-210 Specs

Current: 25A

Voltage: 250V

Temperature Rating: 150°C

Terminals: U Tab (1 2 tab, 2  
4 tab, 1 6 tab)

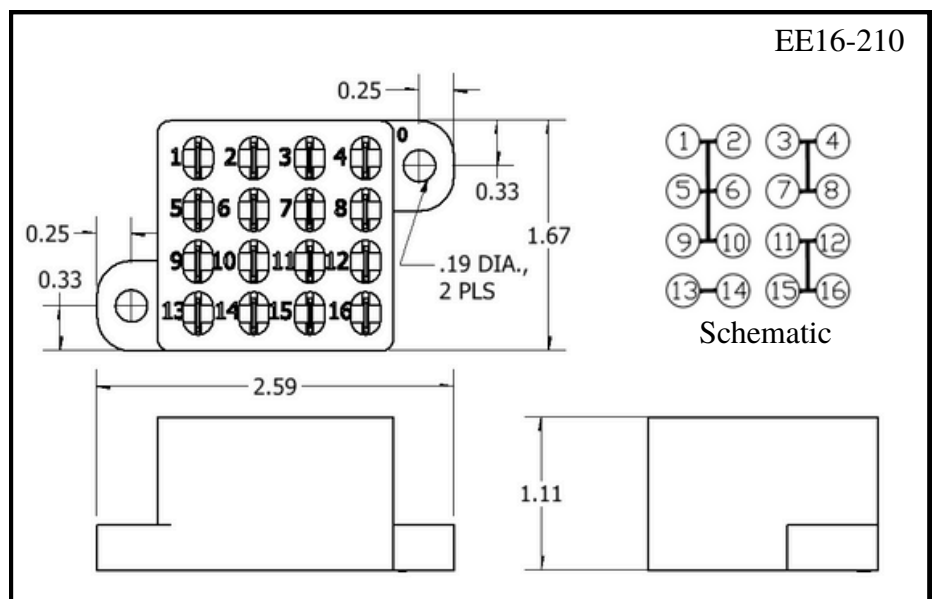

*All dimensions are in inches*